

# ADAYO

## User Manual

DA802 Microstorage

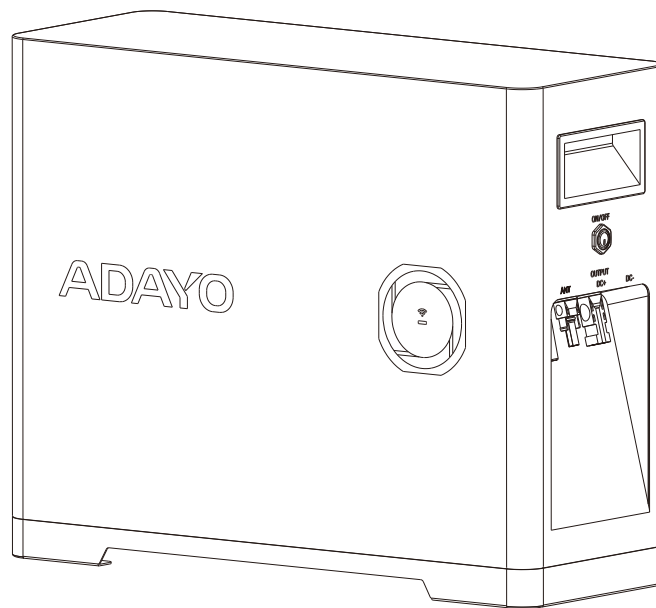

ⓘ Please read the user manual carefully before using the product and keep it for future reference.

## Disclaimer

Thank you for choosing our products and services. Before using the product, please read carefully and fully understand this document to ensure that you can use the product correctly. By using this product, you are deemed to have understood, recognized and accepted all the terms and contents of this document, and the user undertakes to be responsible for his own actions and all consequences arising therefrom.

Incorrect operation of the product or product abnormality caused by force majeure such as fire, typhoon, flood and earthquake may cause unnecessary harm to yourself or others or cause damage to this product and loss of property. All accidents and losses caused by this may have nothing to do with our company. Correspondingly, the service warranty terms promised to you will automatically become invalid.

In compliance with laws and regulations, our company has the final right to interpret product-related documents. If there is any update, revision or termination, no further notice will be given. Our company strives to ensure the accuracy of information such as product functions and features described in the user manual, but does not assume the responsibility for any errors, omissions or subtle differences between the user manual and the product.

If you still have questions, please visit our official website [www.adayopower.com](http://www.adayopower.com) to get the latest product information.

# Contents

1. What's in the package .....	1
2. Overview .....	1
2.1 Product overview .....	1
2.2 Power switch controls.....	2
2.3 Indicators guide .....	2
3. Installing the product .....	3
3.1 Floor mounting .....	3
3.2 Wall mounting .....	3
4. Connecting cables.....	4
4.1 Disconnect old system .....	4
4.2 Connect new system.....	4
5. Using the product .....	5
5.1 Power on .....	5
5.2 Using APP .....	5
6. Storage and Maintenance .....	9
7. FAQ .....	10
8. Specification .....	11
9. Safety instructions .....	12

# 1. What's in the package

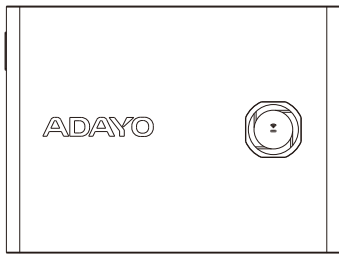

DA802 machine

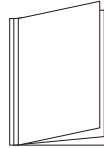

User manual

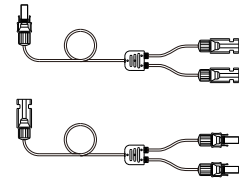

1.5m MC4 Y cable \*2 (optional)



Floor mounting base (optional)

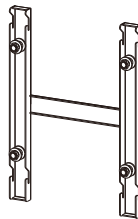

Wall mounting bracket (optional)



Wall mounting hooks \*2 & screws \*12 (optional)

# 2. Overview

## 2.1 Product overview

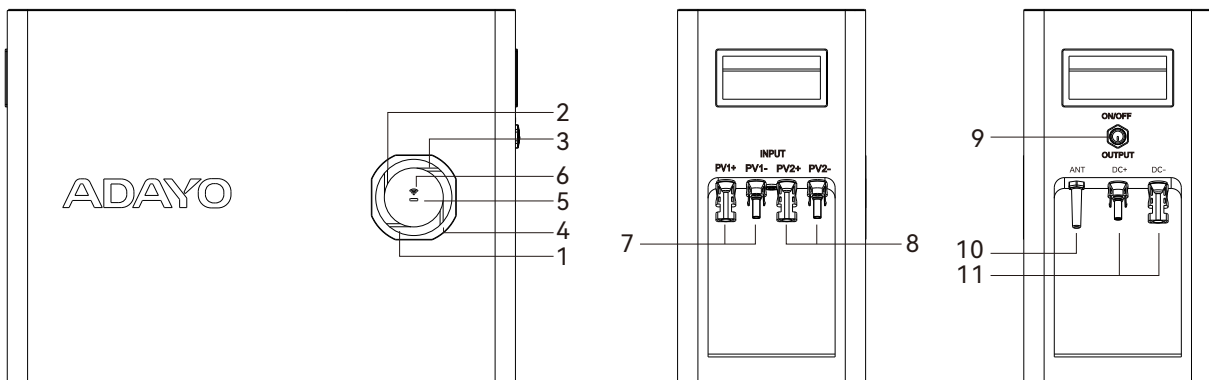

1. Battery level indicator 1	5. Operating indicator	9. Power switch
2. Battery level indicator 2	6. WiFi indicator	10. Antenna
3. Battery level indicator 3	7. PV input 1 ports	11. Output ports
4. Battery level indicator 4	8. PV input 2 ports	

## 2.2 Power switch controls

Action	Function
Press for 3~6 seconds	Switch the machine on or off
Press for 6~10 seconds	Reset the battery
Press for 10~20 seconds	Reset the WiFi of the machine
Press for 20~40 seconds	Unbind the machine from the WLAN

## 2.3 Indicators guide

### 2.3.1 Battery level indicator 1~4

Residual battery energy (SOC)	Indicator 1	Indicator 2	Indicator 3	Indicator 4
$0 < \text{SOC} \leq 25\%$	*1 / *3			
$25\% < \text{SOC} \leq 50\%$	*1 / *3	*1		
$50\% < \text{SOC} \leq 75\%$	*1 / *3	*2	*1	
$75\% < \text{SOC} \leq 100\%$	*1 / *3	*2	*2	*1

	Light	Flashes quickly	Flashes Slowly	Always on
1	Green	Charging	Discharging	Standby
2	Green	/	/	Battery level
3	Red	SOC<10%	BMS has warnings	BMS is protected



Note:

- ① BMS: Battery Management System.
- ② When BMS is protected battery level indicator 2~4 are off. When the machine is not working or is protected all the battery level indicators are off except when BMS is protected.
- ③ \*3 have priority to \*1.

### 2.3.2 Other indicators

Indicators	Green light	Red light	Description
Operating indicator	Off	Off	Machine isn't working
	Always on	Off	Machine is working
	Always on	Flashes slowly	Machine has warnings
	Off	Always on	Machine is protected
$50\% < \text{SOC} \leq 75\%$	Flashes slowly	/	Waiting for connection
	Flashes quickly	/	Connecting
	Always on	/	Connected to the Internet

## 3. Installing the product

### 3.1 Floor mounting

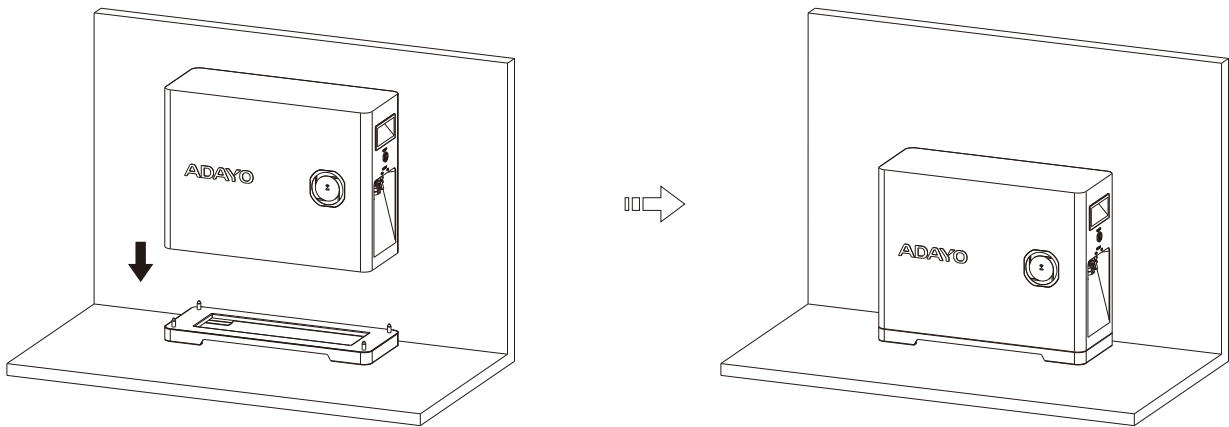

### 3.2 Wall mounting

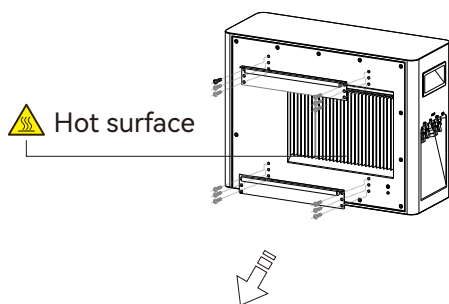

- ① Fix the hooks to the machine.
- ② Fix the bracket to the wall.
- ③ Hang the machine on the bracket.

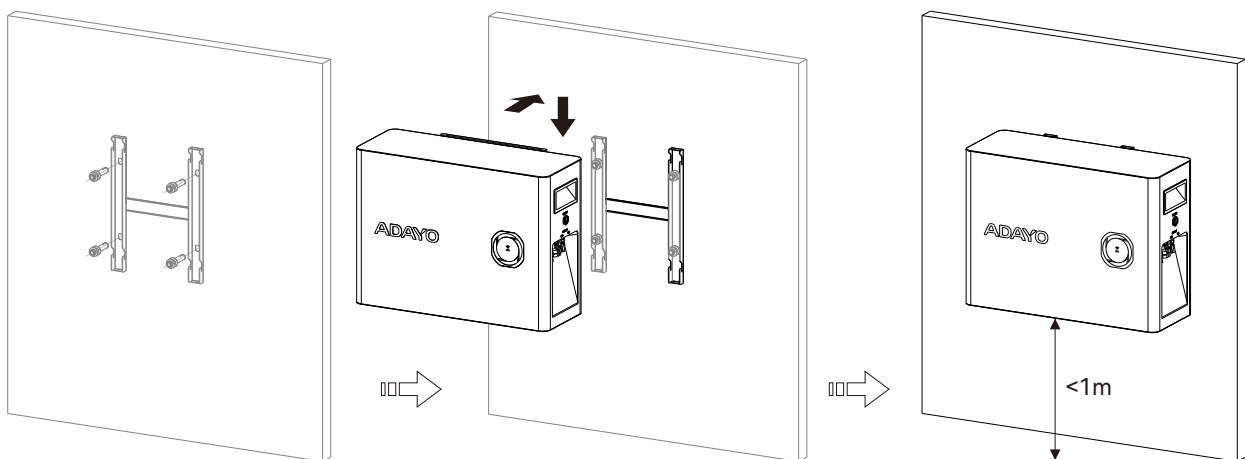

#### Note:

Before installation, please check all accessories and make sure that the machine is power off. And prepare the necessary tools and parts, such as as setscrews, screwdriver, hexagon wrench, work gloves, electric drill, marker pen, tape measure, etc. Those are not included in the purchase.

## 4. Connecting cables

### 4.1 Disconnect old system

- ① Unplug the cable of the microinverter from the grid.
- ② Unplug the cables of the PV panels from the microinverter.
- ③ If you need to replace the old microinverter, remove the installed microinverter.

### 4.2 Connect new system

- ① Connect the machine to the microinverter using the included MC4 Y cables.
- ② Connect the microinverter to the grid outlet using the original cable of the microinverter.
- ③ Connect the PV panels to the machine using the original cables of the PV panels.

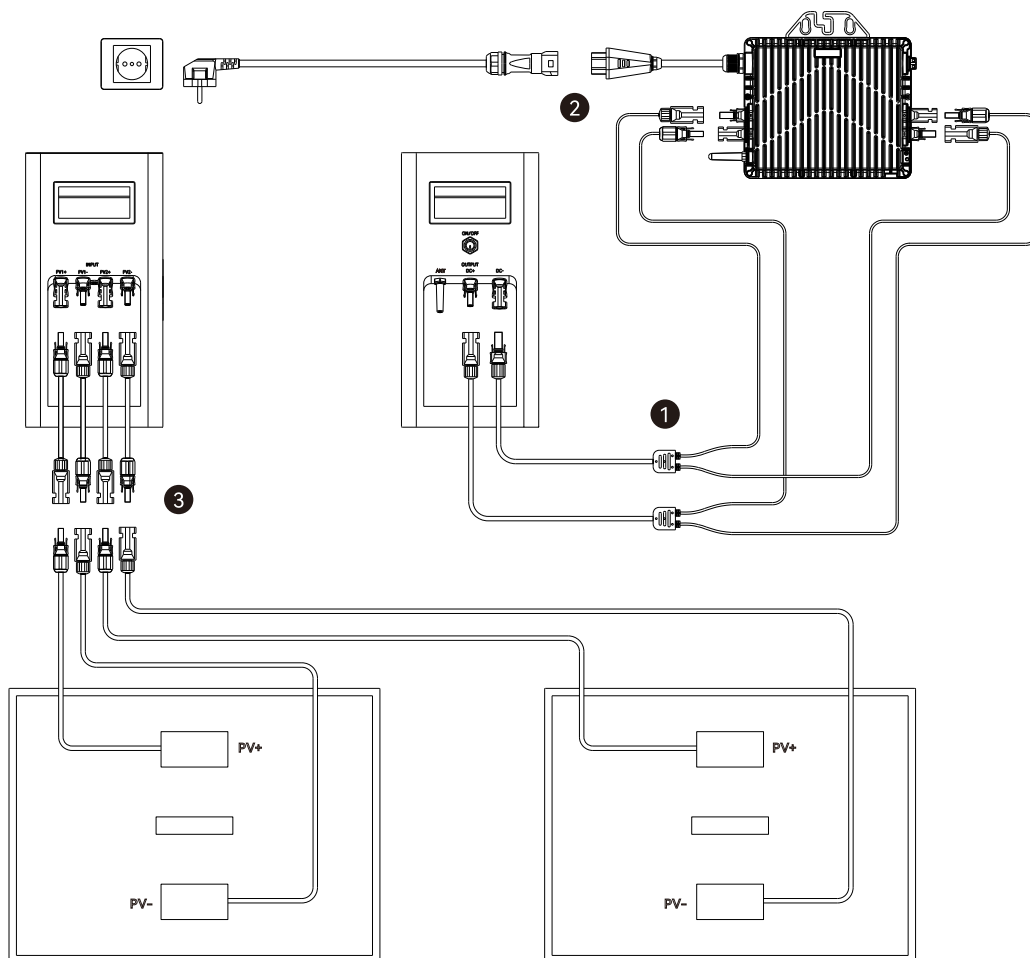

Note:

- ① Before wiring please check all accessories and make sure that the machine is power off.
- ② Before wiring, please confirm the electrical parameters of the connection ports between PV panels, microstorage and microinverter, which must match.
- ③ Please make sure that the microinverter connected by the machine supports that its different input channels are connected to the same source.
- ④ Please install and wire the microinverter according to the requirements of the microinverter.

## 5. Using the product

### 5.1 Power on

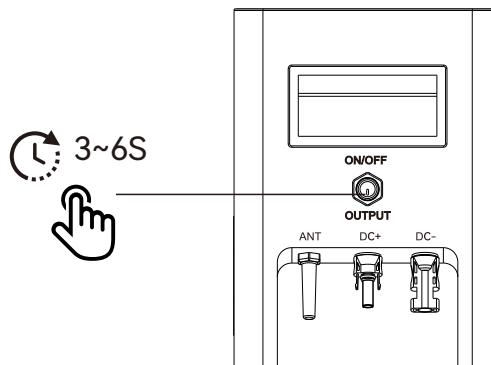

### 5.2 Using APP

- ① Download the “Smart Life” App (  ) from the App Store (iOS devices) or Google Play (Android devices). After installing the APP, sign up for an account and log in.
- ② Make sure the machine is turn on and the mobile phone is connected to WLAN.
- ③ Add the machine to the account using “+” button in the home page of the APP. Then connect the machine to the same WiFi of the mobile phone.

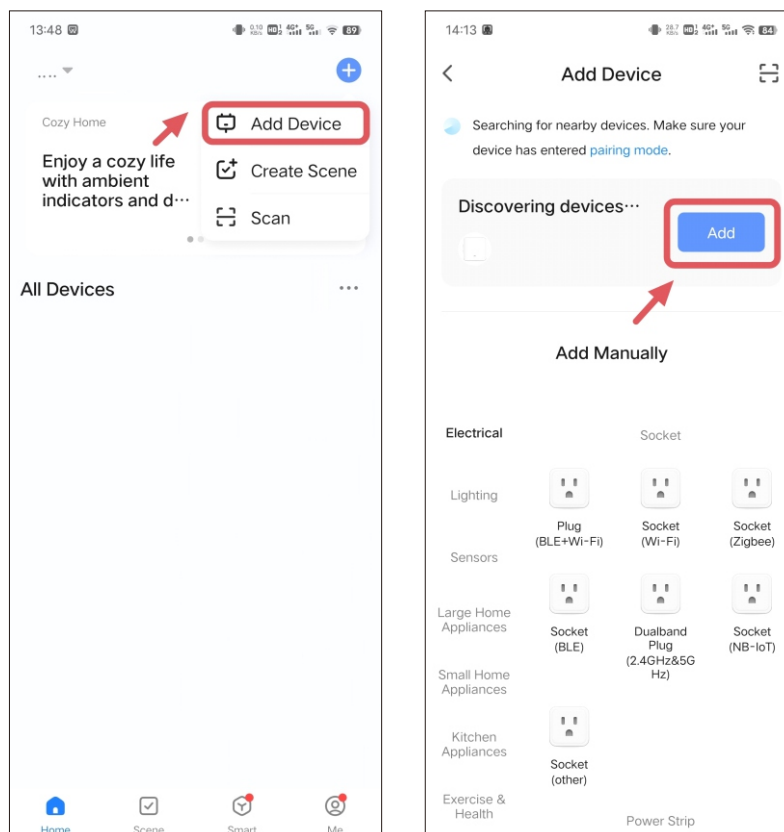



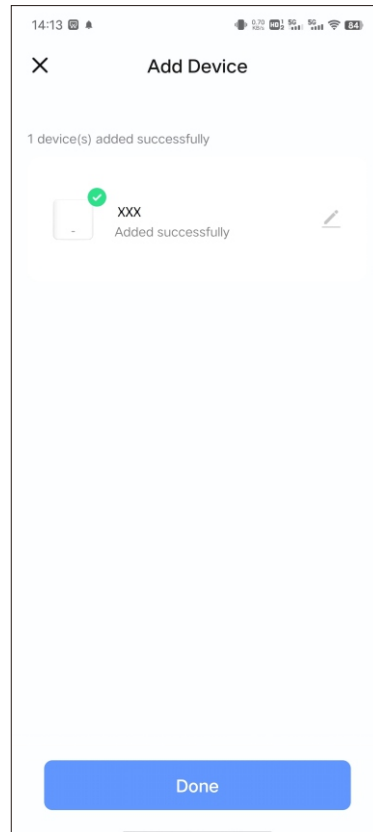
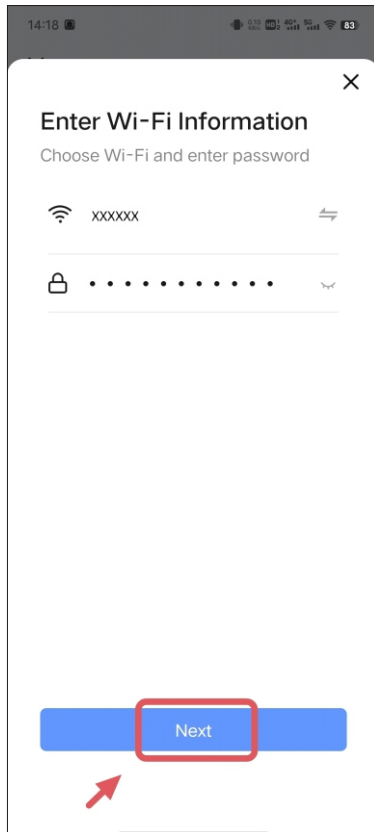

④ Click the device on APP to enter device page. On this page, you can check the operation of the machine and make a plan for adjusting the output power of the machine.

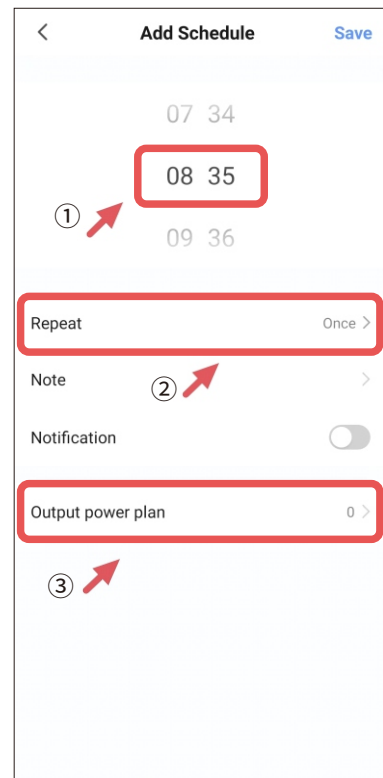
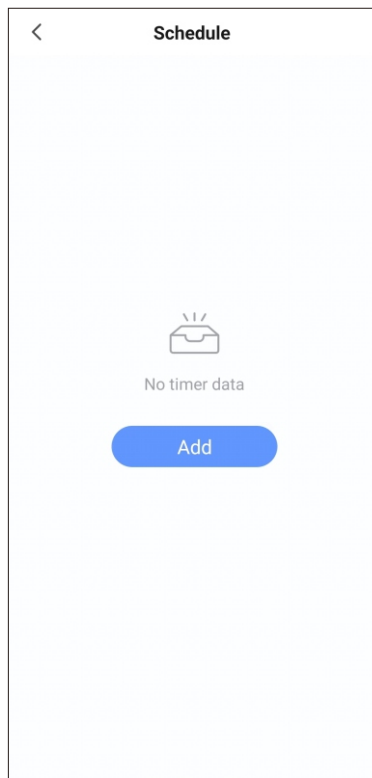
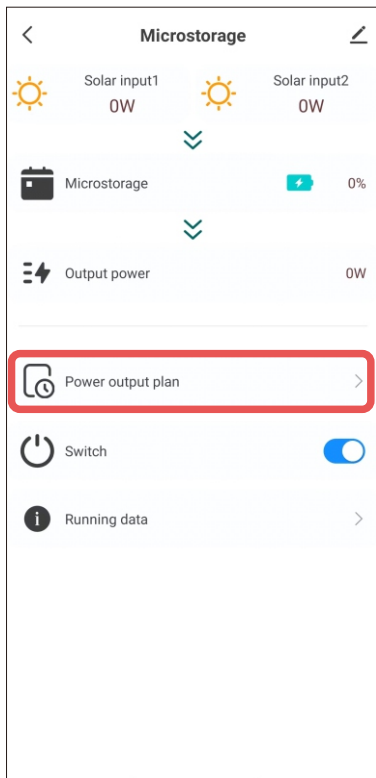

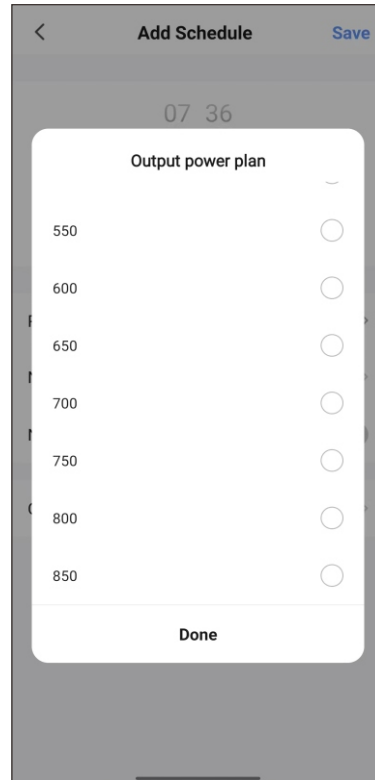
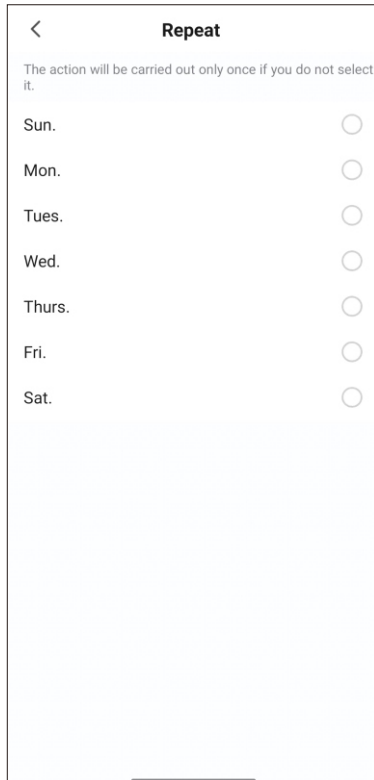

⑤ Can adjust the output power of the machine by a smart plug with power metering function and belonging to the Smart Life APP platform. First add the smart plug to the account. Then create a scene and save it for reacting in chain of the machine and smart plug. When power of the smart plug is greater than a certain value, trigger the machine to adjust output power to the value. Repeat creating scene from 50W to 800W at intervals 50W

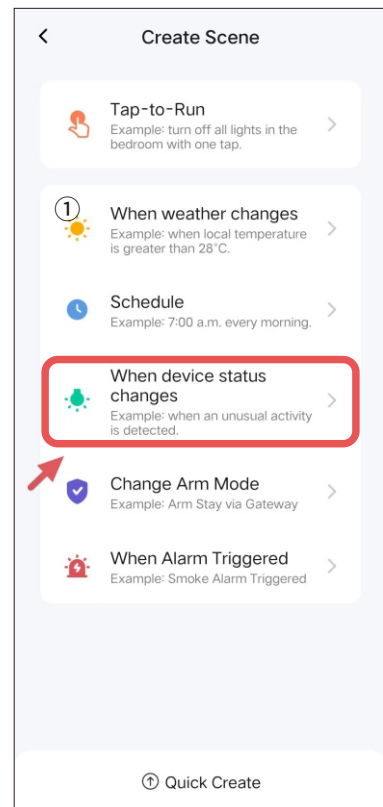
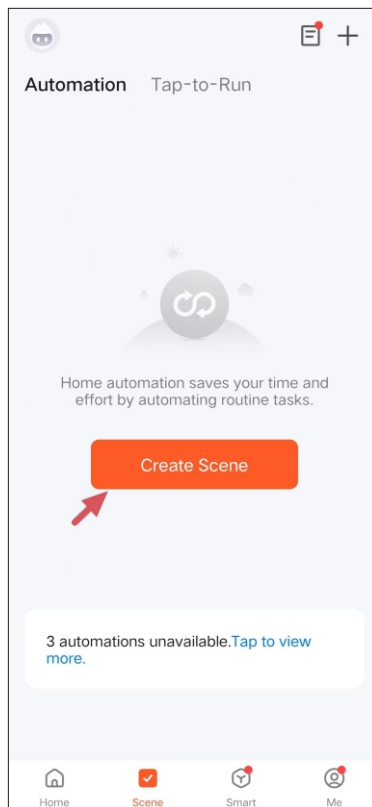
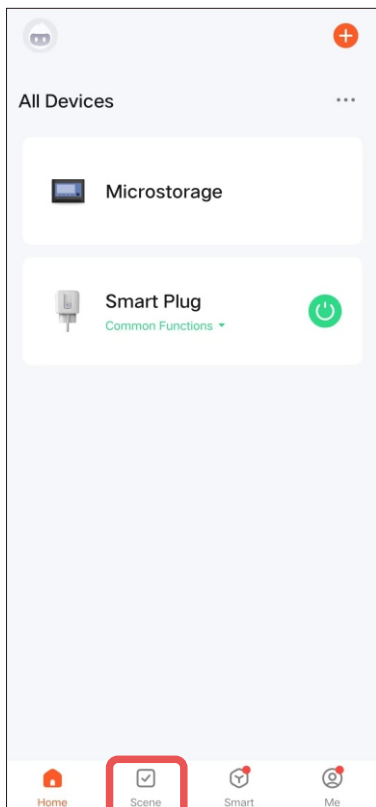

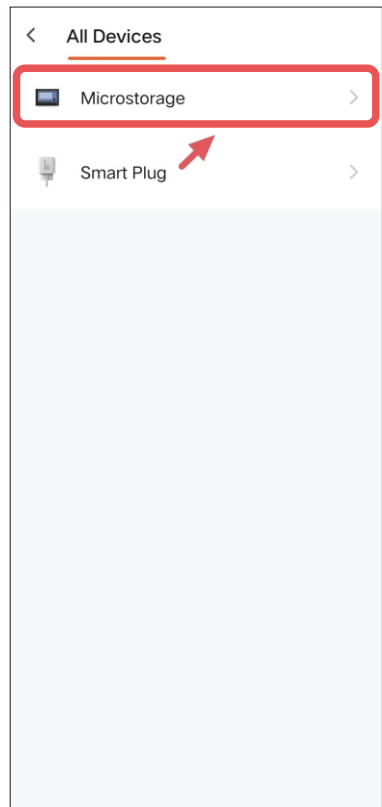
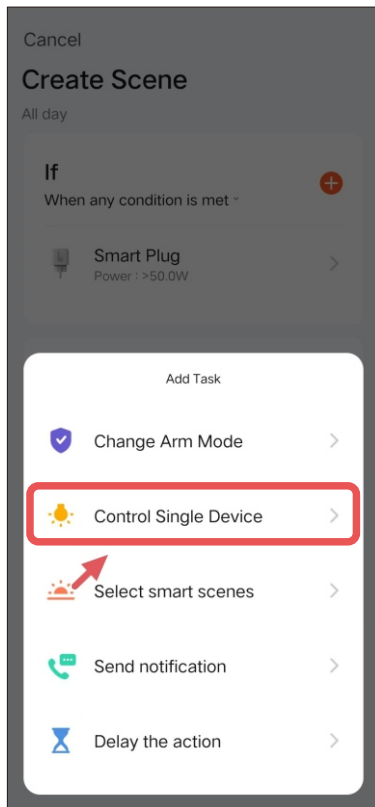
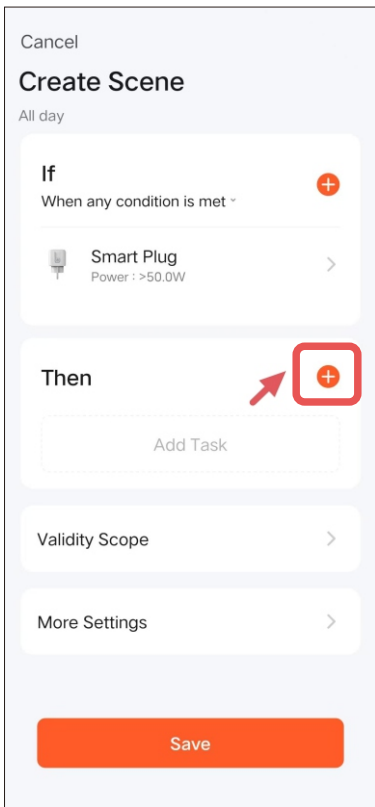
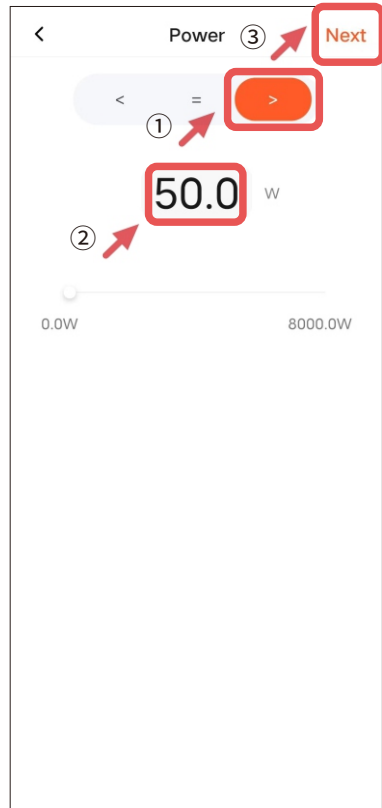
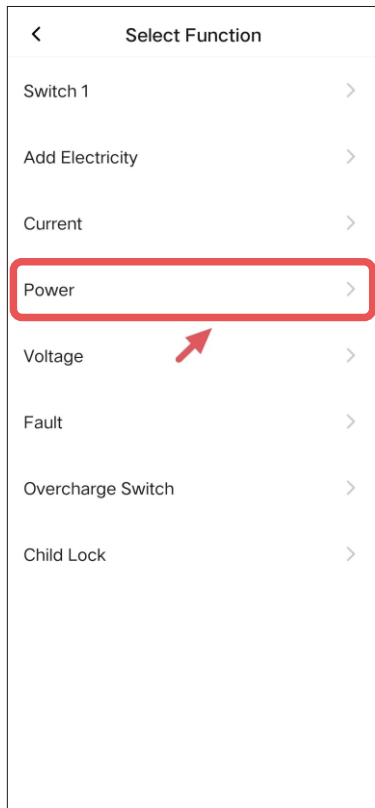
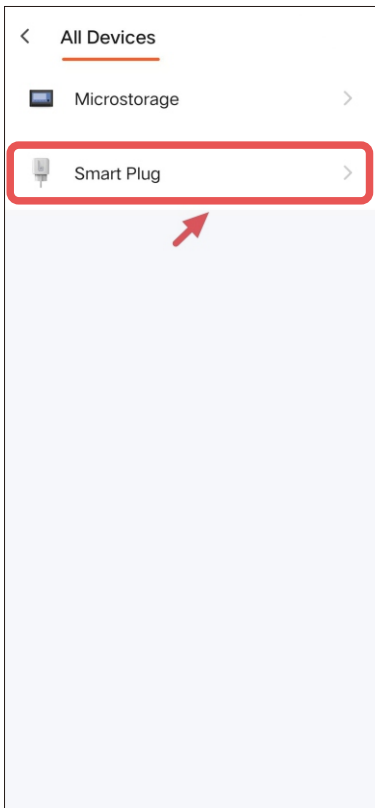

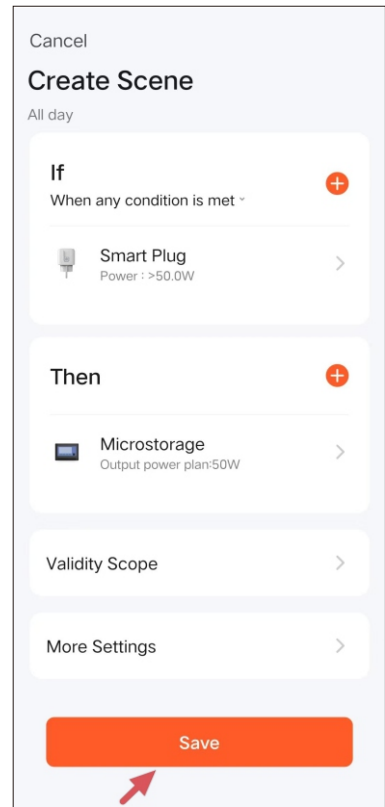
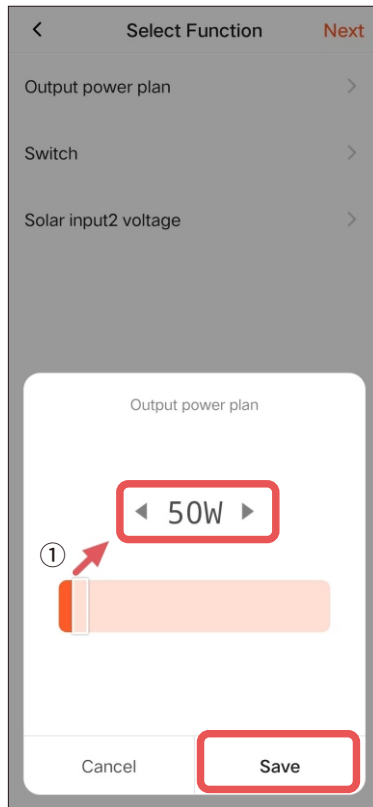
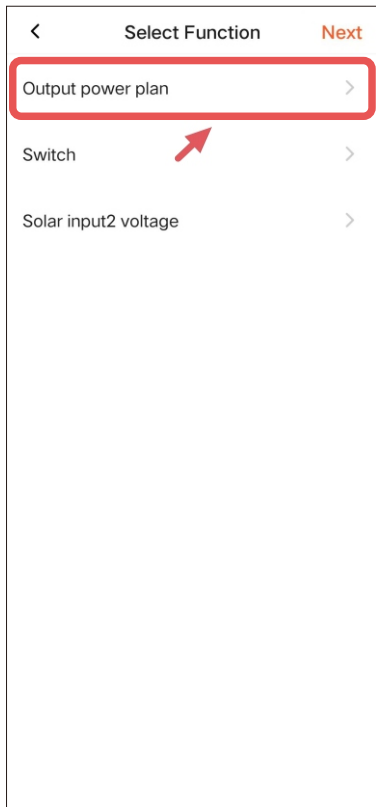

②

 Note:

- ① The APP will be updated from time to time, please refer to the latest version.
- ② There will be a slight difference between the app interface of Android and iOS

## 6. Storage and Maintenance

- Keep the machine on a flat and horizontal fixed surface when using and storing. It should be stored in the temperature range of 0°C~25°C, low humidity and corrosion-free environment, away from heat sources, water sources and metal conductive articles for long time storage.
- In principle the machine should be charged and discharged every 3 months (discharge to 20% SOC, then recharge to 80% SOC) when storing. A possible simplified alternative: charging the machine to 30%+ SOC for short-term storage (<3 months) and to 60%+ SOC for long-term storage(3~12 months).
- After long time storing or transporting the machine should be recharged before use.

## 7. FAQ

### **Q1: Why can't the machine connect to WLAN?**

- ① Make sure the WiFi network is stable and you can connect to the Internet.
- ② If the WiFi signal is weak. Try to move the router closer to the machine, or use a WiFi signal booster.
- ③ Restart the machine and connect again.

### **Q2: Why is there no input of the machine?**

- ① Please confirm the PV panel is properly connected to the machine.
- ② Please make sure there is enough sun light.

### **Q3: Why is there no output of the machine?**

- ① Please confirm battery level. If battery level is very low and there is no PV input, there will be no output.
- ② Check the machine status by indicators. The machine has no output in abnormal protection state.
- ③ Check the microinverter status.

### **Q4: Can a microinverter with much more or less power than the machine be used with the machine?**

In most cases, yes. It depends on the input parameters of the microinverter. Wiring may be different.

## 8. Specification

Item	Specification	Remark
Battery energy	2240Wh	LiFePO <sub>4</sub> , 6000 cycles
Input port	MC4	
Input power	840W max	2*420W, Input from PV panels
Input working voltage	16~60V	Adaptive 210~560+ W PV Panel
Input current	2*14A max	
Rated output power	840W max	Output to microinverter
Output voltage	16~44V	Simulated PV panel output
Working temperature	Charge -10~45°C Discharge -20~45°C	Here is -30~45°C charging and discharging of some other models. *1
Storage temperature	Short-term(<3 months): -20~45°C Long-term(3~12 months): 0~25°C	
Relative Humidity	< 95% (Non-condensation)	
Waterproof rating	IP65	Suitable for outdoor sheltered places
Elevation	< 2000m	
Dimension	50*37*18.5cm	
Weight	about 30.5kg	
Installation	Wall & floor mounting	
Communication	2.4G & 5G WiFi	

### Note:

- ① \*1 : The product of those models has a heating module that is started when the temperature is below 5°C. It requires enough photovoltaic energy input to start the heating and a period time to finish heating.
- ② Due to the characteristics of the battery, the maximum output power of the product will be reduced relative to the rated value when ambient temperature is below 0°C.

## 9. Safety instructions

### IMPORTANT!

Read all instructions before you use this product. Do not make any changes or settings that are not described in this manual. If personal injury, damage, etc. are caused by failure to follow the instructions, the responsibility is not in our company, and the warranty does not apply.

- Install and wire the product correctly, and use the product under specified conditions.
- Do not use the product in extreme environment. Excessive temperature may damage the product and cause danger. If the temperature is too low, the performance of the product will be seriously reduced or stop working.
- Do not use this product near a heat source, such as fire source or heating furnace.
- Please use this product in a dry, well-ventilated place with little dust.
- Do not expose the product to rain, snow or high humidity. Do not immerse it in water.
- Do not use it in strong static electricity or strong magnetic field environment. This may cause the product to work abnormally or the protection function to fail, which may lead to accidents.
- Working at extremely air pressure may cause damage to the product.
- Do not stack more than 50kg weight on the product; Do not stand on the product.
- Please store the product out of the reach of children and pets. Close supervision is necessary when the product is used near children.
- Do not put fingers or hands into the product. Do not insert foreign objects, especially electric conductor, into any port of the product to avoid the risk of electric shock or product damage.
- Do not clean the product with harmful chemicals or detergents.
- Do not operate the product with the damaged electric plug or cable. To reduce risk of damage to the plug and cable, pull the plug rather than the cord when disconnecting the product.
- Ensure that the product is not hit, dropped or violently vibrated. When transporting the product, please firmly fix the product to avoid damage. If the product suffers from severe external impact, please immediately turn off the power supply and stop using it.
- This product must be grounded to reduce the risk of electric shock.
- Do not disassemble the product or puncture it with sharp objects. Take it to a qualified service person when service or repair is required. Incorrect reassembly may result in a risk of fire or electric shock. To reduce the risk of electric shock, disconnect the product wiring before servicing.
- Do not use unofficial parts or accessories. It may result in a risk. If you need to replace it, please go to the sales channel designated by our company for the relevant information.
- Do not use the product and accessories that is damaged or modified. Damaged or modified batteries may exhibit unpredictable behavior resulting in fire, explosion or risk of injury.
- If the product is at risk of serious damage or has been seriously damaged, please immediately cut off the power supply connection to the product and turn off it. Place the product in an open, waterproof and safe place, away from people and flammable materials. Please take measures to prevent electric shock before touching the product. The product shall not be reused and shall be disposed of according to local laws and regulations.
- If the product catches fire accidentally, it is recommended to use fire extinguishing equipment in the following order: sand, fire blanket, dry powder and carbon dioxide fire extinguisher.

**ADAYO**

**Huizhou Foryou Optoelectronics Technology Co.,Ltd.**

[www.adayopower.com](http://www.adayopower.com)